

■ Specifications / External dimensions

● HySiL1500E series

Product Name	HySiL1500E-4	HySiL1500E-2
Number of Lamps	1~4 Lamps	1~2 Lamps
Switching Power	36V : Cosel PJA600F-36	
Supply (Reference)	24V : MEAN WELL HRP-600-24 *Reference power supply for operation. Not included.	
Power Consumption	180W (For 4 Lamps / For 36V) 90W (For 2 Lamps / For 36V)	
Environmental Conditions	Temperature : 0~40°C Humidity : 20~80%RH (Keep away from condensation)	
Compliance Standards	CE Directive 2011/65/EU and 2015/863/EU (RoHS)	
Replacement Lamps	Spot : JIR 36V45W K/5-AG Middle : JIR 36V45W KDM/5-AG Wide : JIR 36V45W KDW/5-AG Spot : JIR 24V28W K/5-AL Middle : JIR 24V28W KDM/5-AL Wide : JIR 24V28W KDW/5-AL	

*Please contact us for more details.

● Products

HySiL 1500E-4



HySiL 1500E-2



【4 Lamps Type】 : L340 × W80 × H100mm

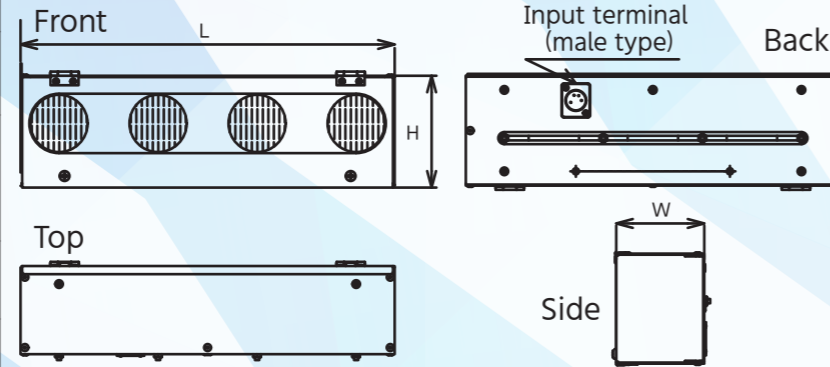

【2 Lamps Type】 : L160 × W80 × H100mm

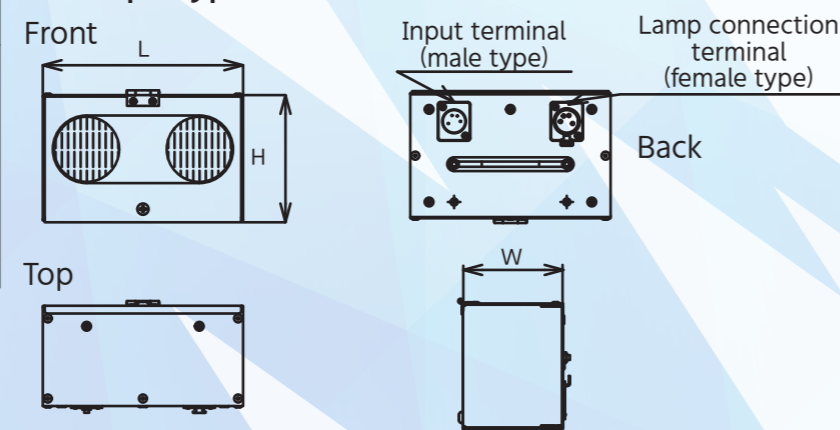

Invisible to Visible

Specialized Imaging Light, Suitable for Hyperspectral and Infrared Cameras

Hyperspectral Imaging Light

HySiL1500



■ Irradiation image

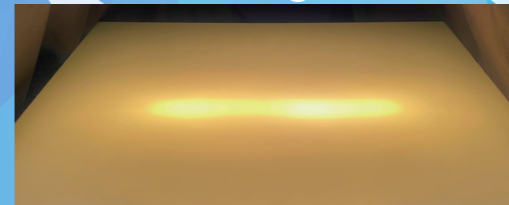

High-intensity near-infrared lighting unit

900nm-2150nm

Kahoku Lighting Solutions Corporation
Sales Office
Nakacho Center Building, 2-23-2 Nakacho, Omiya-ku,
Saitama-shi, Saitama-ken 330-0845 Japan
TEL : +81-48-648-8379 / FAX : +81-48-648-8389
URL : <http://www.kls-co.com/eng/> / Mail : sales@kls-co.com

BLC America
9591 Irvine Center Drive
Irvine, CA 92618
(714) 889-4116
sales@bhc-america.com
www.bhc-america.com

■ Please note that the specifications and appearance are subject to change without notice due to product improvements.
■ The contents of this catalog are current as of April 2024.

Kahoku Lighting Solutions Corporation

Hyperspectral Imaging Light HySiL1500

High-intensity near-infrared lighting unit
900nm–2150nm



High-intensity lighting unit for line area

The center of spectral intensity is around 1300–1400nm. A general-purpose type suitable for high-intensity line and area illumination, 'HySiL 1500'. Two types, a four-Lamps type and a two-Lamps type, are lined up.

Terminal Block Type Product

Four-Lamps type (1 to 4 lights can be lit): HySiL1500E-4

Two-Lamps type (1 to 2 lights can be lit): HySiL1500E-2

HySiL exclusive product

Special Near Infrared HySiL Lamp

High illuminance long life near infrared lamp
900nm–2150nm



Replacement lamp for HySiL1500

The lamp combines our unique filament and reflector. We have prepared two types: high power 36V and heat-suppressed 24V. In addition, we have lined up three different types of light distribution.

Product 36V

Spot : JIR 36V45W K / 5-AG

Middle : JIR 36V45W KDM / 5-AG

Wide : JIR 36V45W KDW / 5-AG

Product 24V

Spot : JIR 24V28W K / 5-AL

Middle : JIR 24V28W KDM / 5-AL

Wide : JIR 24V28W KDW / 5-AL

1 Light Distribution Adjustment Mechanism

The unit has a unique lamp light distribution adjustment mechanism. According to the condition of the irradiated object, it provides the optimal light spread (width) by adjusting the light distribution type, the number of lamp lights, and the pitch distance.

Irradiation image middle light distribution lamp



2 Accurate & Speedy Inspection

By using HySiL1500, high-intensity shooting in the near-infrared region becomes easier. You can capture clear images of things that were not visible before, without slowing down the belt conveyor speed.

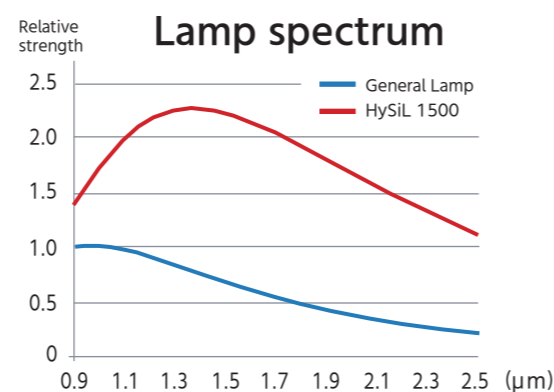

3 Minimum lifetime of 8,000 hours

Comes with a reassuring 1-year warranty. *Based on our company's warranty policy. Achieves long life that was unthinkable with conventional lamps due to our unique lamp design. Compared to general lamps, the lifespan is approximately twice as long.

1 year

warranty

Lamp distribution by application purpose;

Intensity distribution for single-light illumination of each 36V type. Available 3 types distribution.

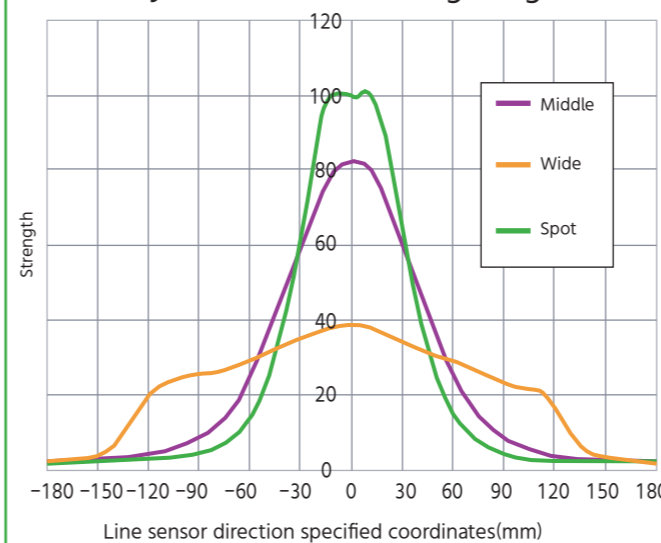

Irradiation image

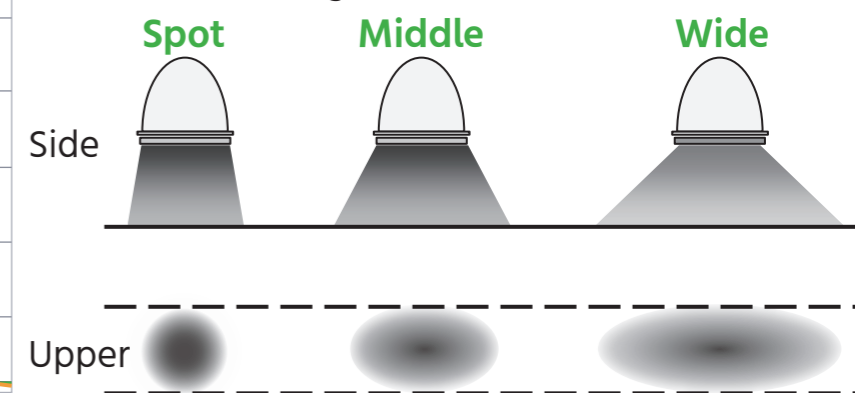

Light distribution according to the situation

By selecting the optimal lamp according to the condition of the irradiated object and adjusting the pitch distance between lines, we achieve line illumination with little unevenness in illuminance.

